

HR23S Series

ATTENUATOR

Au-plated contacts

Low contact resistance

Small size

23.5mm square

Multiple contact

31positions (0dB - Cut off)

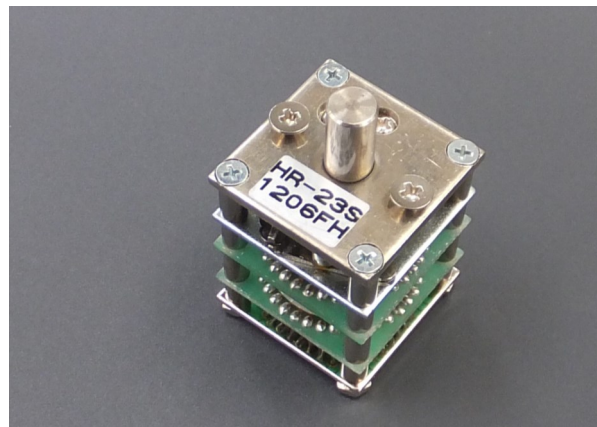

Dimensions

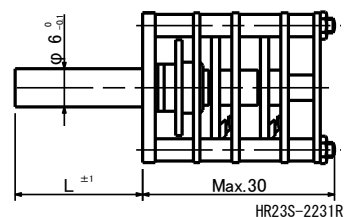
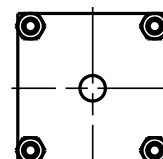
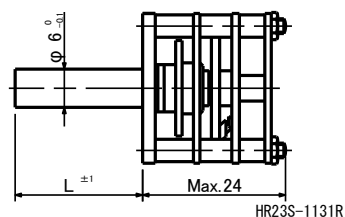
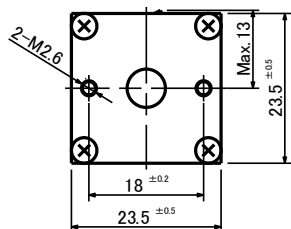

Terminals (Top view) *Terminal number is not printed.

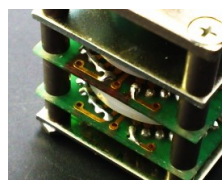
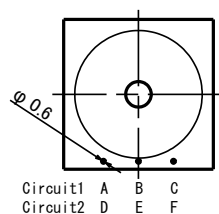

Model number

HR23S	-	1131	R	-	L1	-	10K
Product type		Number of circuit		Control shaft length			Total resistance
		1131: single circuit		L1: 10.5mm			
		2231: 2 circuits		L2: 20mm			

Circuit method

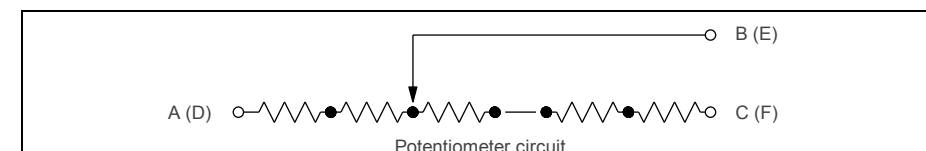

Electrical specifications

	HR23S-1131R	HR23S-2231R
Circuit method	Potentiometer (stepped)	
Attenuation (Load: High)	0, 1, 2, 3, ... (1dB step)..., 11, ... (1.5dB step)..., 20, ... (2dB step)..., 30, 32.5, 35, 37.5, 40, 43, 46, 50, Cut off	
Attenuation accuracy	±0.3dB	
Max attenuation	50dB ±0.5dB	
Cut off	80dB Min.	
Matching accuracy	-	0.2dB or less (0dB - 50dB)
Number of circuit	1	2
Impedance	10kohm, 100kohm ±3%	
Insertion loss	0.3dB or less	
Input level	Max. 0.1W	
Frequency range	DC ~ 20kHz	
Voltage proof	1 Min. at AC100V	
Insulation resistance	100Mohm or more at DC500V	
Rotational life	30,000 Cycles Min. (18cycles/min. Attenuation accuracy: ±0.5dB or less)	

Mechanical specifications

	HR23S Series
Operating angle	300degrees ±2degrees
Step angle	10degrees ±1degrees
Strength of nut-attached	50Ncm
Attached parts	M2.6 x 4mm
Stopper strength	50N
Push-pull strength	50N

Other specifications

	HR23S Series
Temp. range	-10 to +70 degrees C (Operating), -15 to +75 degrees C (Storage)
Relative humidity	90%RH (No condensation)

Note

- * Solder heat resistance: 350degrees C max, 5sec max, 2 times. (Manual soldering only)
- * Please take care during soldering that the smoke from the solder does not flow inside a switch.
- * Special order is not acceptable.
- * High impedance: Infinity. (or more than 20 times of total resistance)