

CPA-9000 Series

PROFADER™

Conductive Plastic

Low sliding noise level & Long sliding life

Good protection against dust

Horizontal style Control-bar design.

High Quality

All parts are highly precise.

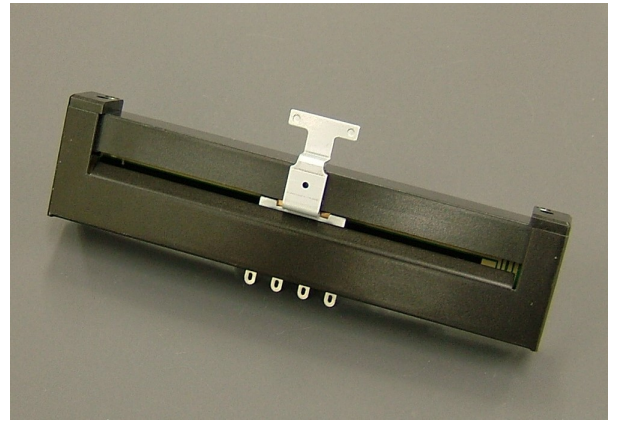

Model number

2 **CPA-9101** **C** **W** - **C** - **UNC** - **B** **10K**

*1 *2 *3 *4 *5 *6 *7 *8

*1	Number of circuit	Blank: Single circuit 2: Two circuits
*2	Product number and Travel	CPA-9101: 100mm CPA-9201: 104mm
*3	Operating force	Blank: Standard C: High operating force *Only "High type" with CP-1 or CP-2 is applicable for the vertical use.
*4	Precision Snap Action Switch	Blank: Without W: With
*5	Click option ("High torque" is not selectable.)	Blank: Without C: Center click (100mm only)
*6	Mounting threads	Blank: M3 UNC: 4-40UNC
*7	Output law (Please see figure of output law.)	Blank: Audio taper B: Linear taper AP: AP taper (100mm only)
*8	Total resistance	10K: 10kohm 5K: 5kohm

Circuit method (Unbalanced)

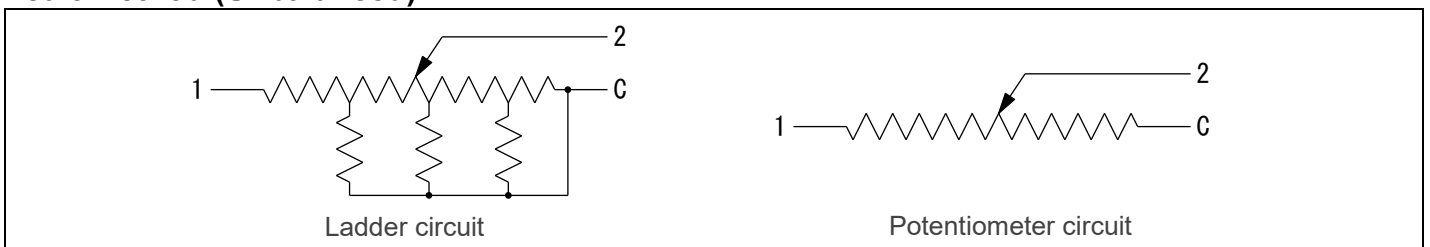

Output Law

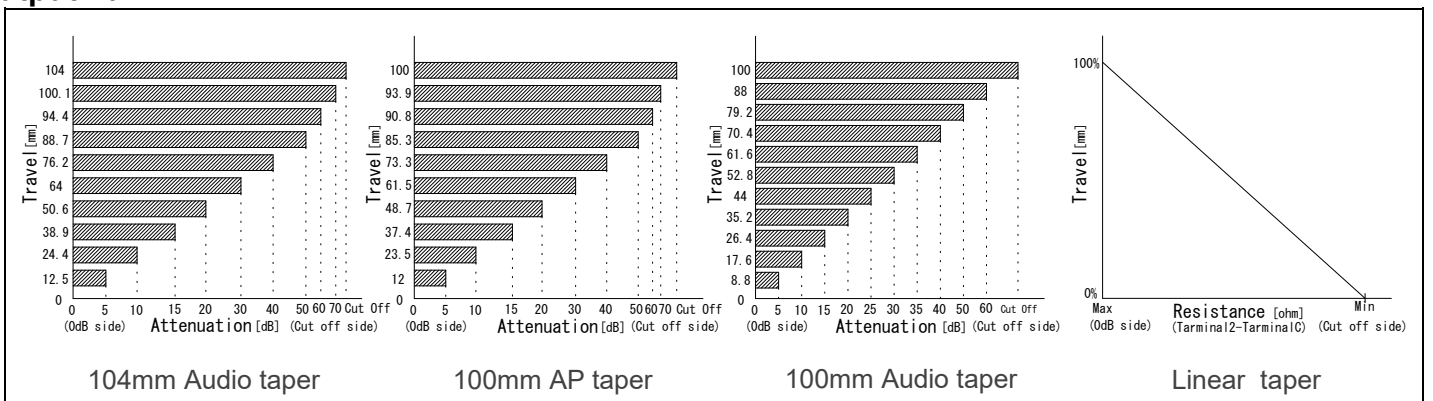

Electrical specifications

	CPA-9101	2CPA-9101	CPA-9201	2CPA-9201	CPA-9101-AP	2CPA-9101-AP
Number of Circuit	1	2	1	2	1	2
Circuit method	Ladder circuit (Audio taper)				Ladder circuit (AP taper)	
Attenuation accuracy (Load: high)	0~20dB: ±1.0dB (10dB: ±0.5dB) ~40dB: ±2.0dB					
Matching accuracy	-	0~15dB: 0.5dB ~30dB: 1.0dB ~40dB: 2.0dB		0~15dB: 0.5dB ~30dB: 1.0dB ~40dB: 2.0dB	-	0~15dB: 0.5dB ~30dB: 1.0dB ~40dB: 2.0dB
Insertion loss	0.5dB or less					
Cut off (15kHz)	100dB Min.					

	CPA-9101-B	2CPA-9101-B	CPA-9201-B	2CPA-9201-B
Number of Circuit	1	2	1	2
Circuit method	Potentiometer circuit (Linear)			
Linearity	±5%			
Residual resistance	30ohm or less			

	CPA-9000 Series
Total resistance (1-C)	5k, 10kohm
Total resistance tolerance	±20%
Voltage proof	1 Min. at AC500V
Insulation resistance	50Mohm or more at DC500V
Max rating	DC20V (0.1W)
Rated Resistive Load - Switch	AC125V 3A, DC30V 2A (OMRON D2F-F)
Sliding noise level	47mV or less (by JIS C 6443)
Sliding life	100,000 Cycles Min. (18cycles/min, Sliding noise level: Less than 100mV)

Mechanical specifications

	CPA-9101 Series	CPA-9201 Series
Stroke length	100mm±0.5mm	104mm±0.5mm
Operating force	0.1~0.25N (Standard), 0.2~0.4N (High operating force, Center click)	
Strength of Nut-Attached	100Ncm	
Attached Parts	M3 screw / 4-40UNC screw (Length: Panel thickness +3mm)	
Stopper strength	50N	
Push-pull strength	40N	

General specifications

	CPA-9000 Series
Temperature range	-10 to +70 degrees C (Operating), -15 to +75 degrees C (Storage)
Relative humidity	90%RH (No condensation)

Note

- * Solder heat resistance: 350deg C max, 5sec max, 2 times. (Manual soldering only)
- * Please take care during soldering that the smoke from the solder does not flow inside a fader.
- * If the flux sticks to a resistor board, it may cause a trouble with the fader.
- * Move to one end in Control-bar on the occasion of knob wearing, and can break into it slowly.
- * It is highly recommended that the fault tolerant system is to be set up in the big situation like the live broadcast.

Dimensions

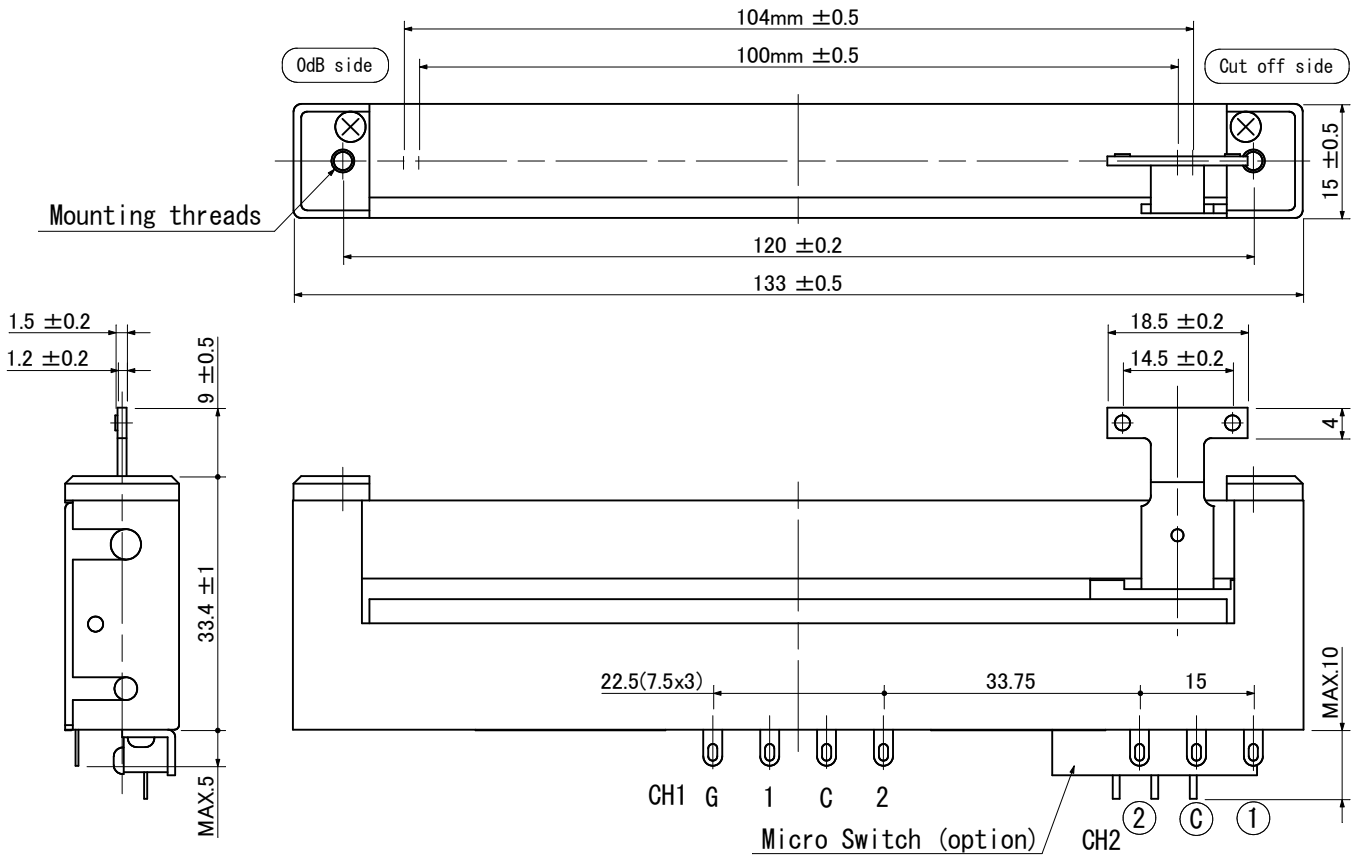

Terminations

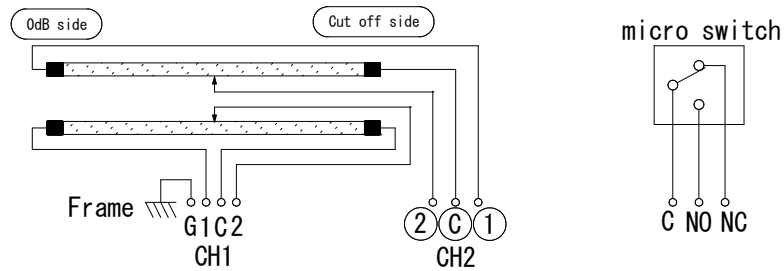

Panel cut out dimensions

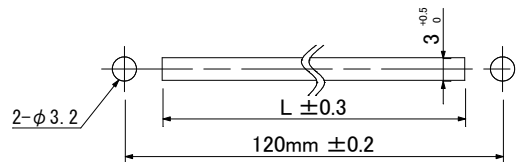

L=110mm CPA-9101
L=114mm CPA-9201

The products and their specifications are subject to change without notice.